

46 Series Casters

The 46 Series Casters are heat treated and recommended in medium heavy duty applications. These are the mainstay in industrial caster applications.

Features

Swivel Section: Cold formed top plate, yoke and button are all heat treated to prevent brinelling, improve swivel action and increase service life. Load and thrust bearings are hardened and ground and rotate on hardened raceways. Top plate and legs are 1/4" steel, legs formed for increased strength and inside and out continuously welded to yoke. All swivel sections are equipped with a lubrication fitting for field maintenance. RWM lubricates all swivel sections prior to shipment. Notched yokes are standard.

Capacity: 1200 lbs.

Kingpin: 5/8" diameter rivet hydraulically compressed to increase strength of swivel section as compared to staking

Axle: 1/2" diameter drilled axle with lubrication fitting provided on all casters to improve ease of lubrication

Finish: Zinc plated to protect from corrosion

Wheels: A wide variety of 3-1/4" through 8" diameters available with either roller, ball bearing, celcon or plain bearings.

Mounting Plate Size: 4" x 4-1/2" x 1/4"

Bolt Hole Spacing: 2-5/8" x 3-5/8" slotted to 3" x 3"

Mounting Bolt Diameter: 3/8"

Applications

Medium Heavy-Duty Casters are the backbone of Material Handling Industry. Nearly every warehouse, freight terminal, manufacturing plant and industrial business use these types of casters in their operations. They are ideal for platform trucks, material handling carts, vending machines, warehouse and factory applications, heavy-duty foodservice and institutional equipment, tool boxes, stock carts, shelf trucks, ground support equipment, bakery carts, a-frame trucks, assembly line dollies, maintenance carts, mobile storage racks and countless other medium duty applications.

Options

- DSL** Demountable Swivel Lock
- FCNB** Face Contact Nylon Brake
- FCNTLB** Face Contact Nylon Total Lock Brake
- FCSTLB** Face Contact Steel Total Lock Brake
- FG** Foot Guard
- FOSL** Foot Operated Swivel Lock
- HT** High Temperature Lubrication
- ICWB** Installable Face Contact Brake
- KB** Nut and Bolt Kingpin
- LT** Low Temperature Lubrication
- SL** Swivel Lock
- SR** Sealed Swivel Raceway
- TG** Thread Guards
- WB** Field Installable Side Wheel Brake on 4" & larger (Roller Bearings Only)
- WS** Wheel Seals
- WBT** Tread Wheel Brake



46-GTB-0620-S



46-GTB-0620-FCNB



46-PNR-0620-S-DSL

SWIVEL CROSS SECTION

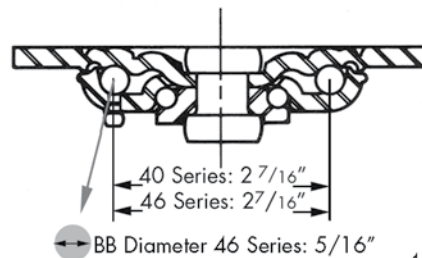

46-UIB-0620-S-FCSTLB

46 SERIES STANDARD TOP PLATE

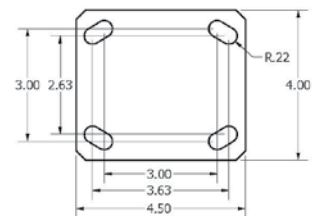

Available NSF Products:

All casters except those with cast iron, soft rubber, rubber on iron, rubber on aluminum, Omega, forged steel, urethane on aluminum, urethane on iron or V-groove wheels. The following options are also not available: DSL, HT, LT, KB, SL, SR, WS, TG. Add "-N" to the end of the model number to specify an NSF approved caster. For example: 46-DUR-0620-S-N.

OPTIONAL OVERALL HEIGHTS

Wheel Diameter	Overall Height
4"	5-1/4"
5"	6-1/8"
5"	6-3/8"
6"	7-1/4"
6"	7-3/8"
6"	7-3/4"
8"	9-1/4"
8"	9-3/4"

UP TO 1,200 POUND CAPACITY

Wheel Diameter	Wheel Width	Wheel Type	lbs. Capacity	Overall Height	Swivel Caster Model Number			Swivel Lead	lbs. Approx Weight	
					Caged, Straight Roller Bearing	Flanged, Sealed Precision, 1 pc. Ball Bearing	Plain, Oilite, Celcon Bearing			
3-1/4"	2"	Durastan	400	5-1/4"	46-DUR-3220-S		46-DUC-3220-S	1-7/16"	6.7	
4"	1-1/2"	Forged Steel	1200	5-5/8"	46-FSR-0415-S		46-FSC-0415-S	1-3/8"	7.0	
4"	2"	Cast Iron	800	5-5/8"	46-CIR-0420-S	46-CIB-0420-S	46-CIC-0420-S	1-3/8"	6.5	
		Durastan	800		46-DUR-0420-S	46-DUB-0420-S	46-DUC-0420-S		5.2	
		GT	1050			46-GTB-0420-S			5.2	
		High Temp Nylon	800		46-HNR-0420-S				5.2	
		Nylatron HD	1200			46-NYB-0420-S				5.7
		Performance TPR	350		46-RPR-0420-S	46-RPB-0420-S	46-RPC-0420-S		5.3	
		Pinnacle	800		46-PNR-0420-S	46-PNB-0420-S	46-PNC-0420-S		5.2	
		Polyolefin	500		46-POR-0420-S	46-POB-0420-S	46-POC-0420-S		4.8	
		Rubber on Aluminum	700			46-RAB-0420-S-EHT			7.4	
		Rubber on Iron	350		46-RIR-0420-S		46-RIC-0420-S		7.5	
		Signature	400		46-SWR-0420-S	46-SWB-0420-S	46-SWC-0420-S		5.5	
		Solid Urethane	700			46-MUB-0420-S			5.5	
		Urethane on Aluminum	700		46-UAR-0420-S		46-UAC-0420-S		5.0	
		Urethane on Iron	700		46-UIR-0420-S		46-UIC-0420-S		6.6	
		Urethane Polypropylene	600		46-UPR-0420-S	46-UPB-0420-S	46-UPC-0420-S		5.3	
V-Groove Iron	800	46-VIR-0420-S		46-VIC-0420-S	7.6					
5"	2"	Cast Iron	1000	6-1/2"	46-CIR-0520-S	46-CIB-0520-S	46-CIC-0520-S	1-11/16"	7.8	
		Durastan	1000		46-DUR-0520-S	46-DUB-0520-S	46-DUC-0520-S		5.4	
		GT	1200			46-GTB-0520-S			5.4	
		Forged Steel	1200		46-FSR-0520-S		46-FSC-0520-S		8.1	
		High Temp Nylon	1000		46-HNR-0520-S				5.4	
		Nylatron HD	1200			46-NYB-0520-S			5.9	
		Performance TPR	375		46-RPR-0520-S	46-RPB-0520-S	46-RPC-0520-S		5.3	
		Pinnacle	1000		46-PNR-0520-S	46-PNB-0520-S	46-PNC-0520-S		5.6	
		Polyolefin	650		46-POR-0520-S	46-POB-0520-S	46-POC-0520-S		4.6	
		Rubber on Aluminum	800			46-RAB-0520-S-EHT			7.5	
		Rubber on Iron	400		46-RIR-0520-S		46-RIC-0520-S		7.6	
		Signature	500		46-SWR-0520-S	46-SWB-0520-S	46-SWC-0520-S		5.7	
		Solid Urethane	1000			46-MUB-0520-S			5.7	
		Urethane on Aluminum	1050		46-UAR-0520-S		46-UAC-0520-S		5.5	
		Urethane on Iron	1050		46-UIR-0520-S		46-UIC-0520-S		7.7	
Urethane Polypropylene	750	46-UPR-0520-S	46-UPB-0520-S	46-UPC-0520-S	5.3					
V-Groove Iron	800	46-VIR-0520-S		46-VIC-0520-S	9.9					
6"	2"	Cast Iron	1200	7-1/2"	46-CIR-0620-S	46-CIB-0620-S	46-CIC-0620-S	2"	9.1	
		Durastan	1200		46-DUR-0620-S	46-DUB-0620-S	46-DUC-0620-S		6.3	
		GT	1200			46-GTB-0620-S			6.3	
		Forged Steel	1200		46-FSR-0620-S		46-FSC-0620-S		10.0	
		High Temp Nylon	1200		46-HNR-0620-S				6.3	
		Omega	1000		46-UOR-0620-S	46-UOB-0620-S			8.8	
		Performance TPR	525		46-RPR-0620-S	46-RPB-0620-S	46-RPC-0620-S		5.7	
		Pinnacle	1200		46-PNR-0620-S	46-PNB-0620-S	46-PNC-0620-S		6.2	
		Polyolefin	700		46-POR-0620-S	46-POB-0620-S	46-POC-0620-S		5.0	
		Rubber on Aluminum	820			46-RAB-0620-S-EHT			7.8	
		Rubber on Iron	410		46-RIR-0620-S		46-RIC-0620-S		7.8	
		Signature	600		46-SWR-0620-S	46-SWB-0620-S	46-SWC-0620-S		6.4	
		Solid Urethane	1200			46-MUB-0620-S			6.4	
		Torus	1200			46-UAB-0621-S			6.1	
		Urethane on Aluminum	1200		46-UAR-0620-S		46-UAC-0620-S		6.1	
Urethane on Iron	1200	46-UIR-0620-S	46-UIB-0620-S	46-UIC-0620-S	8.8					
Urethane Polypropylene	900	46-UPR-0620-S	46-UPB-0620-S	46-UPC-0620-S	5.7					
V-Groove Iron	1000	46-VIR-0620-S		46-VIC-0620-S	10.9					
8"	2"	Cast Iron	1200	9-1/2"	46-CIR-0820-S	46-CIB-0820-S	46-CIC-0820-S	2-1/4"	13.3	
		Durastan	1200		46-DUR-0820-S	46-DUB-0820-S	46-DUC-0820-S		7.7	
		GT	1200			46-GTB-0820-S			7.7	
		Omega	1200		46-UOR-0820-S	46-UOB-0820-S			12.1	
		Performance TPR	600		46-RPR-0820-S	46-RPB-0820-S	46-RPC-0820-S		7.1	
		Pinnacle	1200		46-PNR-0820-S		46-PNC-0620-S		6.9	
		Polyolefin	800		46-POR-0820-S	46-POB-0820-S	46-POC-0820-S		5.8	
		Rubber on Aluminum	1000			46-RAB-0820-S-EHT			10.1	
		Rubber on Iron	500		46-RIR-0820-S		46-RIC-0820-S		10.1	
		Signature	700		46-SWR-0820-S	46-SWB-0820-S	46-SWC-0820-S		7.1	
		Solid Urethane	1200			46-MUB-0820-S			7.1	
		Torus	1200			46-UAB-0821-S			7.3	
		Urethane on Aluminum	1200		46-UAR-0820-S		46-UAC-0820-S		7.3	
		Urethane on Iron	1200		46-UIR-0820-S	46-UIB-0820-S	46-UIC-0820-S		12.1	
		Urethane Polypropylene	1000		46-UPR-0820-S	46-UPB-0820-S	46-UPC-0820-S		7.7	
V-Groove Iron	1050	46-VIR-0820-S		46-VIC-0820-S	15.3					

UP TO 1,200 POUND CAPACITY

OPTIONAL MOUNTING PLATES			
Opt. Top Plate No.	Mounting Plate	Bolt Hole Spacing	Bolt Size
41ST / 41RT	4" x 5"	2-5/8" x 3-5/8" slotted to 3" x 4"	3/8"
42ST / 42RT	4-1/2" x 6-1/2"	2-7/16" x 4-15/16" slotted to 3-3/8" x 5-1/4"	1/2"
43ST / 43RT	5" x 5-1/2"	4-1/8" x 4-1/2"	3/8"

To order a rigid caster, change the "S" to "R" in the model number. For example: "46-DUR-3220-R". To order a rig only, omit the blue letters. For example: "46-3220-S". Dimensions shown are nominal. If precise dimensions are required, consult your RWM representative. For approximate weight of our rigid casters, deduct 0.9 pounds per item.